

P/2017/00141
 Received
 03/02/2017

This drawing to be read in conjunction with all specifications and all other consultants design information. Any contradictions between this drawing and any other design information to be advised to the contract administrator and author immediately.

The contractor to site measure, check and verify all information issued, and confirm the correctness of the contents prior to the commencement on site.

The contractor to comply with all current statutory legislation, Building Regulations, British Standards, and good building practice.

Do not scale from this drawing.

Revision	Date	Init
rev	description	date
		or by
		ap by

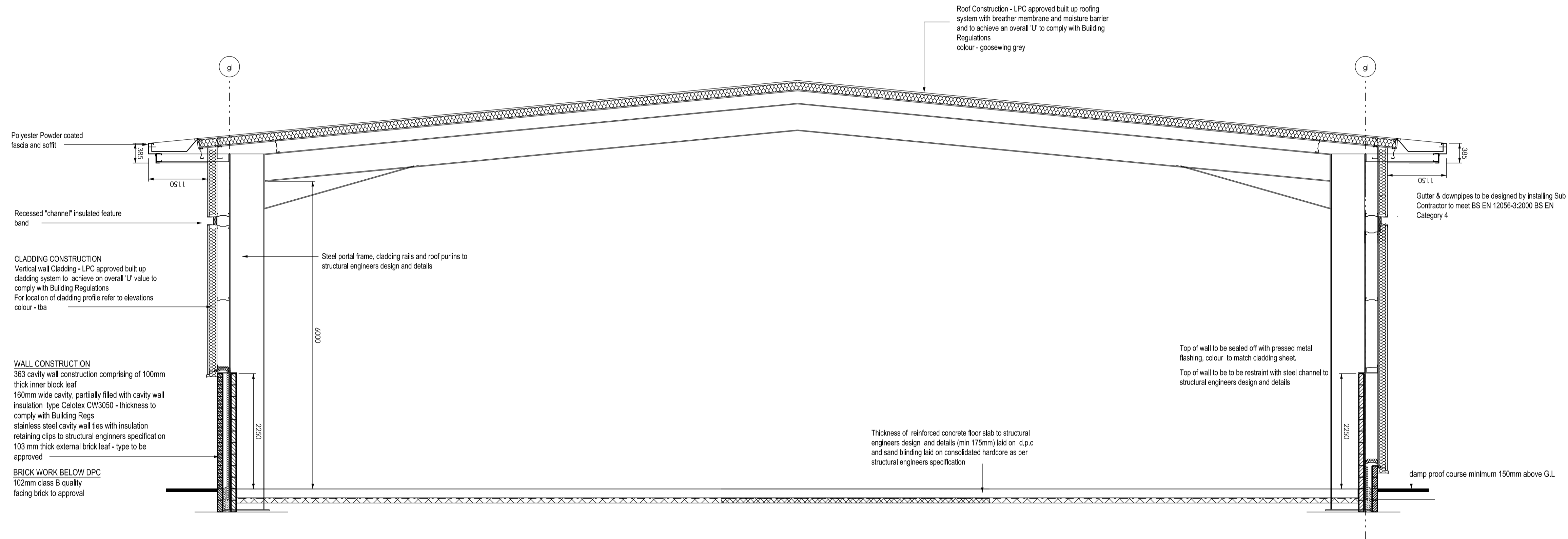

Units 3-4 - Typical Section

client: St Modwen Developments Ltd		
project: Albion Gateway Phase 3 Burton Upon Trent		
title: Building 3 Typical Section		
date: 04.10.16	scale: 1:50@A1	status: Preliminary
drawn by: RD	dwg ref: 16001-3003	rev:
checked by: JW		

The drawing, design and the building works depicted are the copyright of Glancy Nicholls Architects Ltd & may not be reproduced or amended, except by the written permission by Glancy Nicholls Architects Ltd. No liability will be accepted for any amendments made by other persons. The issue of this drawing/document does not confer any license for use of the design to any party whatsoever save as expressly agreed by Glancy Nicholls Architects Ltd.